



**Sea Dog Stainless Steel Handrails**  
Formed 304 Stainless 1" tubing.

Order No	Mfg No	Length	List
352234	254312-1	12"	\$32.19
352245	254318-1	18"	\$41.55
352256	254324-1	24"	\$50.91



**Sea Dog Stainless Steel Grab Rails**  
Formed 304 Stainless 3/4" O.D. tubing.  
5/16" Stud on each end for mounting.  
Protrudes 2" from bulkhead.

Order No	Mfg No	Length	List
264001	254112-1	12"	\$27.35
264002	254118-1	18"	\$33.50
264003	254124-1	24"	\$39.50



**Teak Handrails**  
Helps your passengers, guests and crew avoid slips and falls.  
1-1/16" wide by 2-3/8" high. Loops are 10" long.

Order No	Mfg No	Length	Loops	List
277950	60101	13"	1	\$13.75
264004	60102	23"	2	\$21.40



**Whitecap Hand Rail Ends**  
Cast 316 stainless steel 90° angle ends. Includes 1/4"-28 set screws. 1-1/2" above deck height. For 7/8" rails.

Order No	Mfg No	Mounts	List
240036	6130	Top	\$59.23
240037	6090	Bottom	\$59.28



**Whitecap Safety Grab Handle**  
Molded of high impact plastic, this rugged handle has a soft leather grained vinyl covering for a comfortable, no slip grip which won't corrode or discolor in harsh marine environments. Handle measures 9-1/4" long with a 6-3/4" bridge length and a 1-5/8" finger clearance.

Order No	Mfg No	Color	List
233108	S-7095P	Black	\$11.50
233110	S-7096P	White	\$11.50

## Hardware

### RAIL FITTINGS • GRAB RAILS • TEAK HANDRAILS



**Whitecap Hand Rail Fittings**  
**Forward Handrail Stancheons 120° Angle**  
Predrilled and countersunk for flat head fasteners.  
Each fitting requires two #10 screws.  
Height above deck is 1-1/2" for 7/8" rails, and 1-3/4" for 1" rails.



Order No	Mfg No	Size	Type	Material	List
240177	S-1487C	7/8"	Forward	C/P Zamak	\$9.98
240178	S-1488C	7/8"	Aft	C/P Zamak	\$9.98
240039	6080C	7/8"	Forward	316 SS	\$19.45
240041	6081C	7/8"	Aft	316 SS	\$19.45
231278	6180C	1"	Forward	316 SS	\$27.48
231279	6181C	1"	Aft	316 SS	\$27.48



**Top Mount Center Fittings**  
Predrilled and counter sunk for flat head fasteners. Requires two #10 screws. Height above deck is 1-1/2" for 7/8" rails, and 1-3/4" for 1" rails.



Order No	Mfg No	Tube O.D.	Material	List
240179	S-1489C	7/8"	C/P Zamak	\$9.98
240040	6079C	7/8"	Stainless Steel	\$19.45
231277	6179C	1"	Stainless Steel	\$27.48



**Whitecap Rail End (End In)**  
For 7/8" rails. Predrilled and countersunk for flat head fasteners. Requires two #10 screws. Includes one 1/4"-28 set screw.

Order No	Mfg No	Material	Angle	List
240180	S-1495C	Chrome Plated Zamak	5-1/2°	\$12.75
240046	6049C	Stainless Steel	5-1/2°	\$28.65
240048	6050C	Stainless Steel	16-1/2°	\$32.70



**Whitecap Rail Tee Fittings**  
Includes 1/4"-28 set screws.

Order No	Mfg No	Tube O.D.	Angle	Material	List
240166	S-1443C	7/8"	90°	C/P Zamak	\$11.10
240164	S-1441C	7/8"	60° Left	C/P Zamak	\$11.10
240165	S-1442C	7/8"	60° Right	C/P Zamak	\$11.10
240034	6043C	7/8"	90°	Stainless Steel	\$21.18
240032	6044C	7/8"	60° Left	Stainless Steel	\$24.78
240033	6045C	7/8"	60° Right	Stainless Steel	\$24.33
231235	6143C	1"	90°	Stainless Steel	\$24.03
231234	6144C	1"	60° Left	Stainless Steel	\$27.95
231233	6145C	1"	60° Right	Stainless Steel	\$27.95



**Whitecap 3-Way Corner Fitting**  
Stainless steel.

Order No	Mfg No	Size	List
334902	6046C	7/8"	\$32.85



**Whitecap Bullet End**  
Cast stainless steel construction. Designed to insert into a 7/8" hand rail to protect the end of the tubing.

Order No	Mfg No	List
231276	6229C	\$22.00

## Hardware

### RAIL FITTINGS • HERON RIB

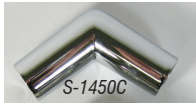

#### Whitecap Bow Form

Includes 1/4"-28 set screws. Fits 7/8" rails.

Order No	Mfg No	Angle	Material	List
240175	S-1450C	110°	C/P Zamak	\$16.13
240043	6086	125°	Stainless Steel	\$46.15



#### Whitecap Round Base Rail Fittings

Predrilled and counter sunk for flat head fasteners.

Three fasteners are required per fitting. 7/8" sizes accept #10 screws, and 1" sizes accept 1/4" screws. Includes 1/4"-28 set screws.

Order No	Mfg No	Tube O.D.	Material	Angle	List
240170	S-1467C	7/8"	C/P Zamak	60°	\$10.93
240174	S-1468C	7/8"	C/P Zamak	90°	\$10.93
240020	6077C	7/8"	Stainless Steel	30°	\$25.35
240021	6014C	7/8"	Stainless Steel	45°	\$32.20
240022	6040C	7/8"	Stainless Steel	60°	\$24.25
240023	6039C	7/8"	Stainless Steel	90°	\$24.25
231287	6140C	1"	Stainless Steel	60°	\$24.35
231288	6139C	1"	Stainless Steel	90°	\$24.35



#### Whitecap Rectangular Base Rail Fittings

Predrilled and counter sunk for flat head fasteners. Four fasteners are required per fitting (except 30° fittings which require three). 7/8" sizes accept #10 screws, and 1" sizes accept 1/4" screws. Includes 1/4"-28 set screws.

#### Chrome Plated Zamak

Order No	Mfg No	Angle	Tube Size	List
240168	S-1465C	60°	7/8"	\$10.93
240169	S-1466C	90°	7/8"	\$10.93

#### Stainless Steel

Order No	Mfg No	Angle	Tube Size	List
240024	6078C	30°	7/8"	\$25.35
240025	6015C	45°	7/8"	\$34.25
240026	6042C	60°	7/8"	\$24.25
240027	6041C	90°	7/8"	\$24.25
231292	6142C	60°	1"	\$24.35
231232	6141C	90°	1"	\$24.35



#### Whitecap H.D. Rectangular Base Rail Fittings

Order No	Mfg No	Material	Tube O.D.	Angle	Base	Screw Size	List
240085	11901	316 SS	1"	4°	3-1/2" x 3"	1/4" (4)	\$70.33



#### Whitecap Rail Elbows

Includes 1/4"-28 set screws.

Order No	Mfg No	Tube O.D.	Material	List
334890	S-1491C	7/8"	C/P Zamak	\$10.43
240045	6076C	7/8"	Stainless Steel	\$22.80
231239	6176C	1"	Stainless Steel	\$28.08



#### Sea Dog Rail Fitting Replacement Parts

304 stainless steel parts for rail fittings 2 pieces per pack.

Order No	Mfg No	Description	List
352597	OP27001-1	1/4-20 x 5/8" Pan Head Screw (only 3/6" has threads)	\$3.78
352608	OP27002-1	3/16" x 1-1/2" Release Pin	\$10.95
352632	OP27006-1	10-24 x 3/4" Round Head Screw	\$2.64
352643	OP27301-1	10-24 x 1" Round Head Screw	\$2.64
352676	OP27601-1	1/4-20 x 3/4" Oval Head Screw	\$2.64

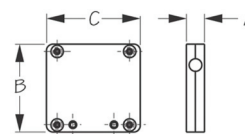

#### Sea Dog Rail Mount Motor Bracket

- Injection molded UV stabilized Polypropylene
- Designed to hold small 2-cycle outboards up to 8 HP upright on the stern rail. These brackets will fit both 7/8" and 1" rails as well as rails using 90° tee fittings.
- Comes complete with fasteners.
- Extra holes allow the use of recommended safety chain to secure the motor.
- Can also be used as mounting platform for barbecues, down rigger brackets, fish cleaning tables, etc.
- White.

Order No	Mfg No	A	B	C	List
354541	327150-1	1-9/16"	6-11/16"	6-11/16"	\$40.95

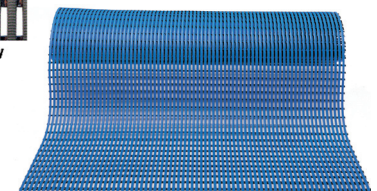
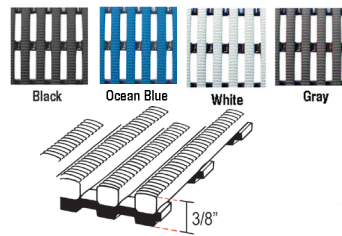

#### Heronrib® Barefoot Matting for the Maritime Industry

- Anti-Fungal and Anti-Bacterial infused
- Excellent drainage is great for protecting the teakwood decking, engine room flooring and compartment lining.
- All around wet side matting provides slip resistant surface.
- Heavy duty, Non porous. Holds up well in tough working conditions and protects the decking from equipment.
- Heronrib® is extremely durable and easy to maintain.

Order No	Mfg No	Width	Color	List/Ft.	List/33 Ft. Roll
131334	8PHRRBBKA3	20"	Black	\$23.02	\$759.59
131336	8PHRRBBKB3	39"	Black	\$41.84	\$1380.79
131341	8PHRRBBLA3	20"	Ocean Blue	\$23.02	\$759.99
131353	8PHRRBBLB3	39"	Ocean Blue	\$41.84	\$1380.79
131364	8PHRRWWA3	20"	White	\$25.58	\$843.99
131375	8PHRRWWB3	39"	White	\$46.49	\$1534.28
131386	H2K1.9x33DGY	20"	Gray	\$23.02	\$759.59
131397	H2K3.3x33DGY	39"	Gray	\$41.84	\$1380.79



# Hardware

## BIMINI TOP SNAPS • BIMINI TOP HARDWARE



### TH Marine Flow-Max Ball Scupper

- Replaces worn out flapper scuppers.
- 70% more drainage than competitive models.
- Twist off for easy cleaning.
- Retrofits all hole patterns.
- Seal is slotted to fit over 1-1/4" motorwell tubes.
- Meets all ABYC standards.

Order No	Mfg No	List
289519	FMS-1-0-DP	\$15.50



### Perko Plastic Cockpit Scupper

Molded white polymer. Flush mount for use with hose. For use when discharge is above the waterline. Insert prevents passage of large objects without restricting water flow.

Hose size: 1-1/2".  
Maximum hull thickness: 1-3/4".  
Flange O.D.: 2-3/4"; I.D.: 1-1/2".



Order No	Mfg No	List
103579	0285DP	\$22.35



### Perko Scupper Valve Assembly

For surface mount applications.  
Molded white polymer with soft black rubber flapper.  
Thru-hull and mounting hardware not included.  
O.D. Flange: 2-7/8".  
Screw size: #6

Order No	Mfg No	List
702591	0365DP	\$18.30



### Beckson Drain Vent

Small vent for deck or bulkhead mount. Raised fins reduce clogging when used as a scupper. Perfect for venting areas under fixed seating too. Color: Black  
Hole Cut = 2-1/4" (5.7 cm) Dia.  
Over All = 4" (10.1 cm) x 2.5" (6.4 cm)

Order No	Mfg No	List
271193	SV-1B	\$7.00



### Forespar Flush Head Drain

High strength glass-reinforced Marelon.  
1-1/2" Hose barb.  
2-3/4" Diameter O.D. Includes nut.

Order No	Mfg No	List
334182	906037	\$35.95

### Nickel Plated Eye Straps

Order No	Mfg No	List
103814	S37190005	\$4.50



### Perko Rope Guides

Chrome plated zinc.  
Hole I.D.: 5/16"  
Base dimensions: 1-1/4" x 3/4"  
Screw size: #6  
2 per pack.



Order No	Mfg No	List
706369	1261DPOCHR	\$10.05



### Whitecap Stainless Steel Eye Strap

2 per pack.

Order No	Mfg No	I.D.	Length	List
240182	S-295C	3/8"	1-5/8"	\$3.33
240183	S-296C	1/2"	2"	\$4.90
240184	S-297C	3/4"	3"	\$5.63



### Indian Mills Make-A-Strap

1" wide nylon webbing in rolls for making your own bimini top straps. Webbing sold in 100 ft. rolls. Buckles and slides sold separately.

Order No	Mfg No	Item	List
230961	F05617	(A) Black Snap Lock Buckle	\$2.40



### Webbing

Sold by the foot.

Order No	Mfg No	Color	Width x Roll Length	List/Ft.
230965	F05627	Black	1" x 100'	\$0.43
101499	WEBW2	White	2" x 300'	\$0.84



### Whitecap Strap Adjuster Buckle

1" single bar to adjust wide strap. For use with 1" webbing. 2 per pack.

Order No	Mfg No	List
240188	S-242C	\$4.05



### Attwood Convertible/Bimini Top White Replacement Strap

Poly web straps, white with rust resistant chrome/brass spring snap hooks and non-mar bow adjusting buckles. Sold in pairs, 62" long.

Order No	Mfg No	List
108441	10628-7	\$20.38



### Adjustable Tie-Down Strap

6' long, fitted with ring at one end and snap on the other end. Sold in pairs.

Order No	Mfg No	Color	List
232867	11993	Black	\$43.65
232868	2000	White	\$43.65



### Eye Straps

Zamak sold in pairs. 1-1/2" long, 5/16" eye.  
Plastic sold in four pack. 1-7/8" long, 1/2" eye.

Order No	Mfg No	Color	List
232864	1225	Zamak	\$7.65
232865	11713	Black	\$3.93
232866	11714	White	\$4.20



Over 350 brand name manufacturers  
Enormous, 50,000 sq. ft. warehouse located next to Ft. Lauderdale International Airport to support all of our customers.

Special orders are no problem.

Selection second to none.

120 years combined marine experience within our sales team - we can find what you need!

Exclusive Wesmar distributor.

Hours: 7:30 a.m. - 4:30 p.m. - Monday - Friday.

Our knowledgeable & friendly staff is ready to help you.

Call Debbie Senti at 954-463-4307 ext. 313

Call Jim Haun at 954-463-4307 ext. 304

Call Lou Moran at 954-463-4307 ext. 314

Call John Carracino 954-732-9570 (Cell)

Email: johnc@dshullco.com

Call Pamela Hutchisson at 954-463-4307 ext. 322

Call Bob Leatherman at 954-463-4307 ext. 305 (Wesmar)



### Whitecap Stainless Steel D-Ring

2 per pack.

Order No	Mfg No	Size	List
240181	S-243C	1-1/8" Opening	\$5.75

Prices and specifications subject to change without notice.

## Hardware

### BIMINI TOP SNAPS • BIMINI TOP HARDWARE



Whitecap Bronze Fast Eye Boat Snap

Order No	Mfg No	Hook	Eye	Length	Size #	List
244193	S-1120C	1/4"	3/4"	2"	0	\$5.93



Whitecap Bronze Swivel Eye Boat Snap

1" snap, stainless steel. 2 per pack.

Order No	Mfg No	Hook	Eye	Length	Size #	List
108223	S-1104	5/8"	3/4"	3-1/4"	1	\$10.40
108225	S-1106C	1"	7/8"	4-9/16"	3	\$14.85



Whitecap Bronze Fast Eye Boat Snap

1" snap, stainless steel. 2 per pack.

Order No	Mfg No	Hook	Eye	Length	Size #	List
108224	S-1121	5/16"	5/8"	3-3/8"	1	\$7.65
108227	S-1123C	1/2"	3/4"	3-7/8"	3	\$14.58



Whitecap Stainless Steel Swivel Eye Boat Snap

Order No	Mfg No	Hook	Eye	Length	Size #	List
244079	S-4021C	3/8"	5/8"	3-1/4"	1	\$15.88
244080	S-4022C	1/2"	3/4"	4"	2	\$18.88
244081	S-4023C	7/16"	3/4"	4-3/4"	3	\$21.23



Whitecap 316 S.S. Trigger Snap

Order No	Mfg No	Hook	Eye	Length	List
377563	S-4100P	7/16"	1/2"	2-5/8"	\$14.20



Taylor Stainless Steel Dog Snaps

1" snap, stainless steel. 2 per pack.

Order No	Mfg No	List
232762	1340	\$7.45



Taylor Stainless Steel Baby Snaps

3/4" eye, 2" overall. 2 pack.

Order No	Mfg No	List
232874	1341	\$11.34



External Eye End

Sold in pairs.

Order No	Mfg No	Size	Color	List
232896	1203	3/4"	C/P Zamak	\$15.42
232897	11705	3/4"	Black	\$5.07
232898	11706	3/4"	White	\$5.07
232857	11206	7/8"	C/P Zamak	\$17.43
232858	11707	7/8"	Black	\$6.60
232859	11708	7/8"	White	\$6.60



Jaw Slide

Sold in pairs.

Order No	Mfg No	Size	Color	List
232893	1209	3/4"	C/P Zamack	\$18.00
232894	11709	3/4"	Black	\$6.60
232895	11710	3/4"	White	\$6.60
232848	11210	7/8"	C/P Zamack	\$18.75
232849	11711	7/8"	Black	\$6.60
232850	11712	7/8"	White	\$6.60
335485	6100RC	7/8"	Stainless Steel	\$26.48

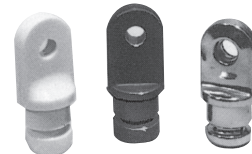

Internal Eye End

Sold in pairs.

Order No	Mfg No	Size	Color	List
232697	1202	3/4"	C/P Zamak	\$9.78
232699	11702	3/4"	White	\$3.75
232860	11207	7/8"	C/P Zamak	\$11.04
232861	11703	7/8"	Black	\$3.75
232862	11704	7/8"	White	\$3.75

## Hardware

### BIMINI TOP HARDWARE



**Top Mount Deck Hinge**  
2 per pack.

Order No	Mfg No	Color	List
232851	1204	C/P Zamak	\$17.34
232852	11717	Black	\$7.44
232853	11718	White	\$7.44



**Side Mount Deck Hinge**

Sold in pairs. Mounts vertically on side walls.

Order No	Mfg No	Color	List
232854	1205	C/P Zamak	\$18.03
232855	11721	Black	\$4.71
232856	11722	White	\$4.71

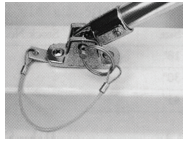

**Pull Pins**

Stainless steel. Replaces the screws in stainless steel and zamak deck hinges. Allows fast and easy mounting or removal of a bimini top. Comes complete with safety lanyard to prevent lost pins. Sold in pairs.

Order No	Mfg No	List
232847	11227	\$26.43



**Adjustable Bimini Support Pole**

Use these poles to replace your rear straps and keep your top "up and out of the way". Adjusts from 28" to 48". Two 7/8" jaw slides are included. Anodized aluminum.

Order No	Mfg No	List
232813	11995	\$99.38



**Windshield Top-Lok**

Stainless steel. Stud portion affixed. Four per pack. Fits 3/4" windshield trim.

Order No	Mfg No	List
232876	1348	\$12.45



**Slide Assembly**

Fold your bimini top behind the rear seat. Easy installation. Fits most deck hinges. Non-locking. sold in pairs.

Order No	Mfg No	List
232886	993030	\$45.48

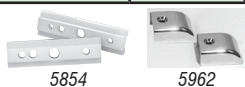

**Slide Assembly Replacement Parts**

Sold in pairs.

Order No	Mfg No	Item	List
232881	5854	Nylon Slides	\$3.18
232884	5962	Zamak End Caps	\$12.87



**Attwood Convertible/Bimini Top Slider Kit**

For custom adjustment of bimini top, while in use or in storage. Kit contains two high impact white nylon jaw slides with stainless steel nuts and bolts, two 36" aluminum slider tracks, and two end caps. Easy to drill and mount.

Order No	Mfg No	List
108440	10605-5	\$40.25



**Heavy Duty Deck Hinge & Top Cap Assembly**

Cast stainless steel.  
fits 1" tubing. Base size: 1" x 2.1".  
Bolt size: 5/16"-18. Requires two 1/4" fasteners (not included).

Order No	Mfg No	List
240061	6154	\$60.55



**Cap**

Cast stainless steel. Accepts 1/4" pin. Includes 1/4"-28 set screw.

Order No	Mfg No	Size	Type	List
240055	6101C	7/8"	Standard	\$13.55
231244	6103C	1"	Standard	\$14.68
231249	6159C	1"	Heavy Duty	\$26.33



**Top Slide W/Bolt**

Cast stainless steel.  
Includes 1/4"-20 pin and 1/4"-28 set screw.

Order No	Mfg No	Size	Type	List
240056	6100C	7/8"	Standard	\$14.53
231245	6102C	1"	Standard	\$15.55
231250	6158C	1"	Heavy Duty	\$34.23



**Whitecap Stainless Steel Quick Release Pins**

Order No	Mfg No	Size	Features	List
377146	S-1019C	1/4" x 1-5/8"	w/lanyard	\$16.75
377157	S-1020C	1/4" x 1"	w/lanyard	\$15.33
377168	S-1021C	1/4" x 1"	w/flip tab	\$26.53
377179	S-1025C	5/16" x 2-7/16"	w/lanyard	\$20.58



**Stainless Steel Concave Base Deck Hinges**

Predrilled and counter sunk for two #10 screws. Can be mounted on any curved surface or rail. Equipped with either a 1/4" spring loaded removable pin, or a 1/4"-20 threaded pin.

Order No	Mfg No	Type	List
231246	6200C	w/Removable Pin	\$21.38
231248	6221C	w/Threaded Pin	\$21.63



**Stainless Steel Flat Base Deck Hinges**

Predrilled and counter sunk for two #10 screws. Can be mounted on any flat surface or rail. Equipped with either a 1/4" spring loaded removable pin, or a 1/4"-20 threaded pin.

Order No	Mfg No	Type	List
231247	6220C	Removable Pin	\$19.58
240057	6104C	Threaded Pin	\$16.75
231251	6108C	Heavy Duty	\$21.30
231252	6213C	With Plate	\$24.58



**Angle Base Deck Hinge**

316 Stainless steel.  
Base size: 7/8" x 2". Bolt size: 1/4" - 20.  
Fasteners: #10 (2).

Order No	Mfg No	List
240058	6222C	\$14.48



**Side Mount Deck Hinge**

Cast stainless steel.  
Predrilled and counter sunk for two #10 screws.  
Bolt is 1/4"-20 threaded.

Order No	Mfg No	List
240059	6109C	\$13.18



**Top Slide with Bolt**

316 S.S. Top Slide with 1/4" - 20 Bolt  
Weight - 5.8 oz. With 1/4-28 set screws.

Order No	Mfg No	Tube Size	List
335485	6100RC	7/8"	\$26.48
377191	6102RC	1"	\$36.13



**Southco Stainless Steel Lanyard Assemblies**

300 series stainless steel.  
Vinyl coated. Tab is aluminum.

Order No	Mfg No	Length	List
383385	LW-1023-4-6-00	6"	\$17.99



954-463-4307 • D.S. Hull Company, Inc. • www.dshullco.com

# Hardware

VINYL TRIM • STARBOARD LUMBER • TUBULAR INSULATION • TEAK TRIM • TEAK DRAWER PULLS



## Whitecap Teak Lumber

Order No	Mfg No	Thickness	Width	Length	List
264094	60808	3/8"	5-3/4"	12"	\$21.90
264105	60809	3/8"	5-3/4"	36"	\$77.80
264116	60810	3/8"	5-3/4"	60"	\$134.73
264127	60812	1/2"	1-3/4"	36"	\$31.15
264149	60816	7/8"	3-3/4"	12"	\$21.90



## TACO Flexible Vinyl Rub Rail Kits

Rugged and durable. Popular on bass boats, runabouts, open fisherman boats. Kits include 50' each of black vinyl rub rail and insert with end caps and screws in a pie box. Also includes instruction sheet. Black color with black insert. Choose insert color below. Length: 50'.



Order No	Mfg No	List
369083	V11-2423BBK50-2	\$586.43

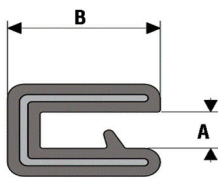
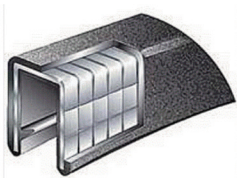

## Taco Marine Flex Trim

Covers the unfinished edge and follows almost any contour or radius. Flexible PVC trim with individual internal aluminum clips and gripping tongue.. 5 year limited warranty. 25 ft. rolls.

Order No	Mfg. no.	Opening (A)	Width (B)	Color	List
287283	V30-1008B25-1	1/4"	1/2"	Black	\$74.28
287284	V30-1008W25-1	1/4"	1/2"	White	\$74.28
287315	V30-1005B25-1	9/16"	5/32"	Black	\$74.28
287324	V30-1005X25-1	9/16"	5/32"	White	\$74.28



## D.I.Y. Marine Starboard Lumber

U.V. stabilized marine grade polymer, which makes an excellent choice for applications where there is exposure to sun and saltwater. Will not rot, delaminate, swell or splinter. Matte texture requires no painting, finishing or maintenance. Lasts for the lifetime of your boat. Projects using Starboard Lumber range from replacing damaged wood to adding accessories.

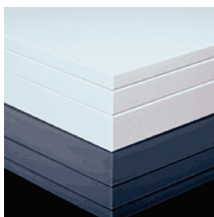

Order No	Mfg No	Color	Dimensions	List
369353	P10-2524BLK54-1	Black	24" X 54" X 1/4"	\$117.43
369103	P10-5012BLK27-1	Black	12" x 27" x 1/2"	\$61.50
369112	P10-5024BLK27-1	Black	24" x 27" x 1/2"	\$116.33
369364	P10-5024BLK54-1	Black	24" X 54" X 1/2"	\$220.43
369375	P10-7512BLK27-1	Black	12" X 27" X 3/4"	\$90.63
369295	P10-2524WHA541	White	24" x 54" x 1/4"	\$117.43
369014	P10-5012WHA27-1	White	12" x 27" x 1/2"	\$61.50
369025	P10-5024WHA27-1	White	24" x 27" x 1/2"	\$116.33
369036	P10-5024WHA54-1	White	24" x 54" x 1/2"	\$220.43
369124	P10-7512WHA27-1	White	12" X 27" X 3/4"	\$90.63
369135	P10-7524WHA27-1	White	24" X 27" X 3/4"	\$170.45
369386	P10-5012SFM27-1	Sea Foam (Off White)	12" X 27" X 1/2"	\$61.50

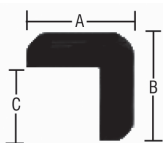

## Teak L-Molding

5 ft. lengths.

Order No	Mfg No	A	B	C	List
264038	60844	7/8"	7/8"	5/8"	\$31.45
264037	60843	1-3/16"	1-3/16"	13/16"	\$42.45

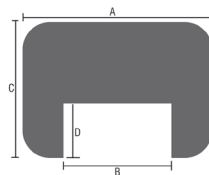

## Teak Bulkhead Molding

5 ft. lengths.

Order No	Mfg No	A	B	C	D	List
264032	60821	7/8"	1/2"	5/8"	1/4"	\$23.93
264033	60825	1-3/16"	3/4"	5/8"	1/4"	\$30.33

## Teak Outside Edge Corner Molding

2" inside radius. 2-1/2" outside radius.



Order No	Mfg No	List
264052	60837	\$21.55



## Drawer Pulls

Recessed mount. 2 per package.

Order No	Mfg No	Diameter	Depth	List
264059	60127-A	1-3/8"	3/8"	\$3.20

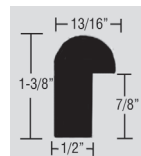

## Teak Edge Molding

5 ft. lengths. Dimensions: 1-3/8" x 13/16" outside, 7/8" x 5/16" track.

Order No	Mfg No	List
264034	60835	\$47.75



## Teak Quarter Round Molding

5 ft. lengths.

Order No	Mfg No	A	B	List
264040	60851	3/8"	3/8"	\$10.53
264039	60850	1/2"	1/2"	\$11.15



## Teak Stop Molding

5 ft. lengths.

Order No	Mfg No	A	B	List
264042	60854	3/8"	3/8"	\$10.38
264041	60853	3/8"	3/4"	\$16.30

# Hardware

## TEAK MOLDINGS & TRIMS • TEAK PLUGS • ZIPPER LUBRICANT



**Teak Finger Pulls**  
Recessed mount.

Order No	Mfg No	O.D.	Depth	List
264062	60145-A	1-1/4"	5/8"	\$3.65
264063	60146-A	1-1/4"	1"	\$4.25



**Teak Battens**  
3/8" high.  
5 ft. lengths.

Order No	Mfg No	A	B	List
264047	60860	3/8"	7/8"	\$17.43
264046	60859	3/8"	1-3/16"	\$19.95
264045	60858	3/8"	1-7/16"	\$25.73
264044	60857	3/8"	1-7/8"	\$29.05
264043	60855	3/8"	3"	\$47.75



**Teak Plugs**  
In packages of 20.

Order No	Mfg No	Size	List
264048	60150	1/4"	\$2.45
264049	60151	3/8"	\$3.35
264050	60152	1/2"	\$3.65
279159	60153	5/8"	\$6.38



### Starbrite White Teflon Snap & Zipper Lubricant

Use on boat snaps, metal and plastic zippers to protect against corrosion, reduce wear and friction, prevent binding and repel salt spray deposits. Non-toxic, non-staining. Will not wash off. 2 oz. tube.

Order No	Mfg No	List
231512	89102	\$13.18



### Shurhold Snap-Stick Snap and Zipper Lubricant

May be applied directly to the head of a snap, along a zipper or even on the barrel of a hinge without causing a mess. One application can last up to three months. Non-toxic, biodegradable and harmless to fabrics, plastics and metals. .45 oz. tube.

Order No	Mfg No	List
120524	251	\$6.63

### Anodized Aluminum Flat Stock

1/8" thick.

Order No	Mfg No	Size	List
298510	6862	1/8" x 3/4" x 6'	\$15.73
298517	6868	1/8" x 1" x 6'	\$17.90
298523	6874	1/8" x 1-1/2" x 6'	\$22.80

### Anodized Aluminum Angle

Order No	Mfg No	Size	List
298547	6882	1/16" x 1/2" x 72"	\$9.48
298552	6886	1/16" x 3/4" x 72"	\$10.63
298563	6892	1/16" x 1" x 72"	\$15.83
298559	6898	1/8" x 3/4" x 72"	\$20.43
298570	6904	1/8" x 1" x 72"	\$7.43

### Aluminum Tubing

Ideal for hand rail repairs. Wall thickness is .058".

Order No	Mfg No	Size	List
298611	6934	Anodized 3/4" x 72"	\$22.78
244443	A23-7858BLY6-1	Drawn 7/8" x 72"	\$40.50
244444	A23-7858BLY12-1	Drawn 7/8" x 144"	\$72.70

### Stainless Steel Flat Stock

1/8" thickness. 3' lengths.

Order No	Mfg No	Size	List
298640	7209	1/8" x 3/4" x 36"	\$27.00
298647	7215	1/8" x 1" x 36"	\$33.88

### Stainless Steel Angle Stock

Order No	Mfg No	Size	List
298661	7309	1/8" x 1" x 1" x 36"	\$67.33



### Taco Stainless Steel Rail Tubing

Highly polished. Type 304. 3/64" wall thickness. SOLD BY THE LENGTH.

Order No	Mfg No	Size	Length	List
369179	S14-7849P12-1	7/8"	12'	\$98.15
369182	S14-1049P6-1	1"	6'	\$60.13
369193	S14-1049P12-1	1"	12'	\$120.98



### Marine Industries

#### Stainless Steel Mouldings

All RSE Stainless Steel items are highly polished. Rub Strakes - Mfg. no. 304 - RBSTRK Stainless steel. Formed on two ends.

Order No	Mfg No	Dimensions	List
268200	1700-8	3/4" x 8"	\$8.75
268201	1700-12	3/4" x 12"	\$9.98
268202	1700-18	3/4" x 18"	\$11.38
268203	1700-24	3/4" x 24"	\$15.75
268205	1800-12	1" x 12"	\$11.55
268206	1800-18	1" x 18"	\$14.35
268207	1800-24	1" x 24"	\$19.95
268209	1900-12	1-1/4" x 12"	\$15.93
268210	1900-18	1-1/4" x 18"	\$19.32
268211	1900-24	1-1/4" x 24"	\$26.08



### Marine Industries Rail Ends

Stainless steel. Formed on one end.

Order No	Mfg No	Size	List
268213	2000-12	3/4" x 12"	\$11.38
268217	2100-12	1" x 12"	\$11.55



### Marine Industries Solid Half Oval Rub Rail

Stainless steel. 3/4" rub rail is predrilled for #10 fasteners at 6" centers, 1" rub rail is predrilled for #12 fasteners at 6" centers. SOLD BY THE LENGTH.

Order No	Mfg. no.	Size	Length	List
268227	12-1400-187	3/4"	12'	\$223.44
268228	12-1500-250	1"	12'	\$342.72



### Marine Industries Half Oval Rub Rail

Stainless steel. Predrilled for #8 fasteners at 6" centers. In 12' lengths. SOLD BY THE LENGTH.

Order No	Mfg. no.	Size	Length	List
268224	12-1100-077	3/4"	12'	\$67.20
268225	12-1200-077	1"	12'	\$75.18
268226	12-1000-077	1-1/4"	12'	\$94.50



### Taco 9/16" x 5/8" Canvas & Upholstery Track/Welting

Rigid vinyl.

Track for canvas tops, bolsters, canvas tops, enclosures.

Order No	Mfg. no.	Length	List/Ft.
120043	V25-9207WHA20	20'	\$4.49

